



KCCM-WF 1/4" + 3/8"

2372948-06.2024

100

KWIK CAST CONNECT
KCCM-WF 1/4" + 3/8"
GRN-PNK
#2363084

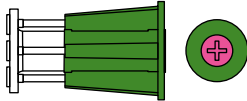

Info | Shop



qr.hilti.com/2363084

Batch Tracking
Information

Made in Taiwan
Hilti = trademark of Hilti Corp., Schaun, LI

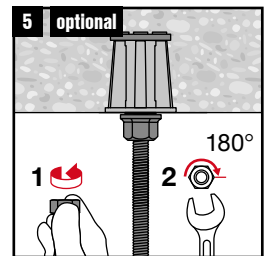
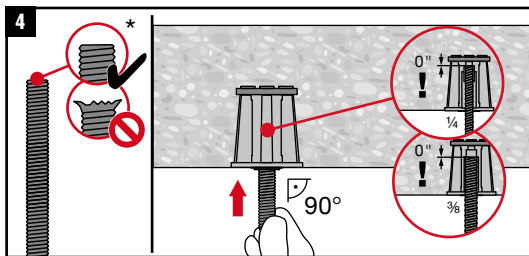
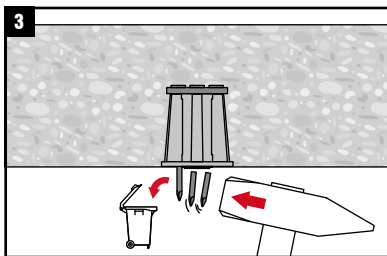
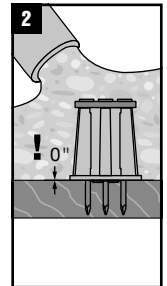
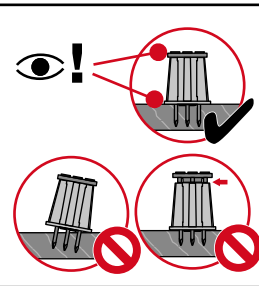
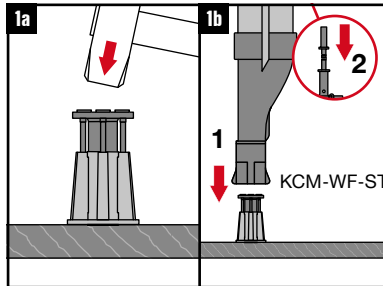
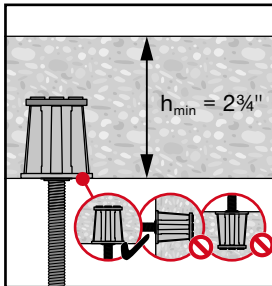

UL Listing does not cover the 1/4-inch rod size. *End of rod must be free of burrs. When using a high-strength rod (>55 ksi) end must be chamfered.